

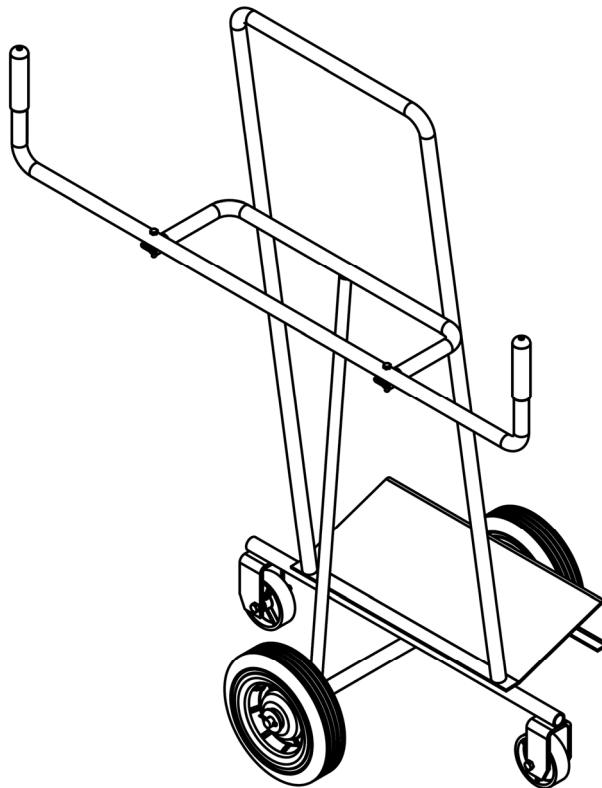

Vestil Manufacturing Corp.
 2999 North Wayne Street, P.O. Box 507, Angola, IN 46703
 Telephone: (260) 665-7586 -or- Toll Free (800) 348-0868
 Fax: (260) 665-1339
 Web: www.vestilmfg.com e-mail: info@vestil.com

HT-PANEL Series Panel Carts Instruction Manual



Receiving instructions:

After delivery, remove the packaging from the product. Inspect the product closely to determine whether it sustained damage during transport. If damage is discovered, record a complete description of it on the bill of lading. If the product is undamaged, discard the packaging.

NOTE: The end-user is solely responsible for confirming that product design, installation, use, and maintenance comply with laws, regulations, codes, and mandatory standards applied where the product is used.

Table of Contents

Specifications.....	2
Signal words.....	2
Hazards of Improper Use.....	2
Exploded parts diagrams and bills of materials.....	3
Assembly instructions.....	3 - 4
Loading instructions.....	5
Maintenance.....	5
Labeling diagram.....	5
Limited warranty.....	6

Specifications:

Dimensions and other specifications appear in the diagrams and table below.

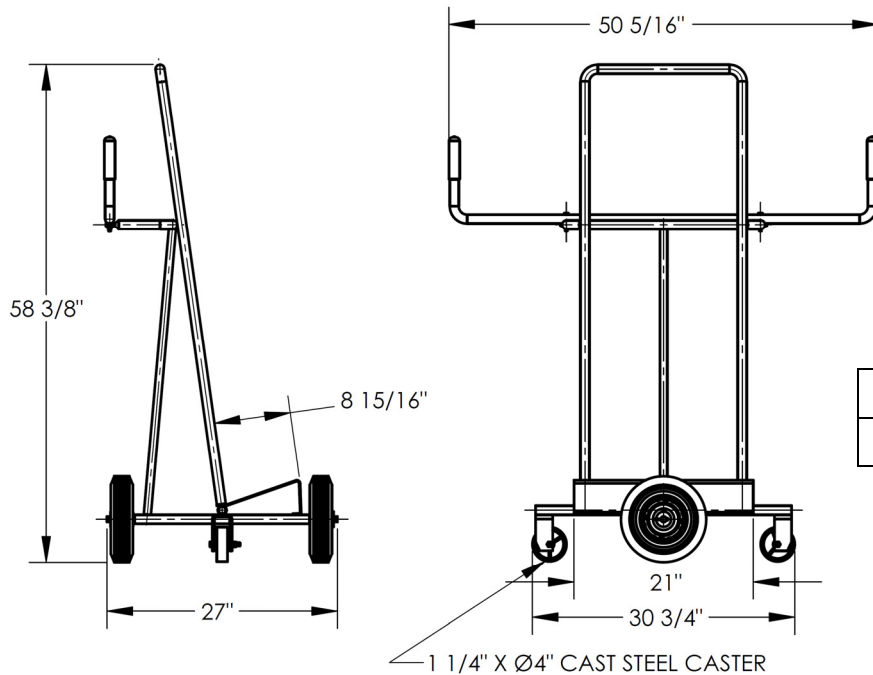

Static Capacity	Net weight
750 lb. (341kg)	138 lb. (62.5kg)

SIGNAL WORDS:

This manual uses SIGNAL WORDS to call attention to uses of this product that are likely to result in personal injuries or property damage. The signal words used in this manual appear below along with their definitions.



Identifies a hazardous situation which, if not avoided, COULD result in DEATH or SERIOUS INJURY.



Identifies practices likely to result in product/property damage, such as operation that might damage the product or other property.

Hazards of Improper Use:

Study the entire manual before using this cart. A copy of the manual should be available to users at all times. Read the manual whenever necessary to refresh your understanding of the recommended operation, inspection, and maintenance procedures.



Improper or careless operation might result in serious personal injuries.

- Do not exceed the 750 lb. capacity.
- Center and evenly distribute all loads applied to the cart.
- Only use this cart on level, even ground. Do not use the cart on sloped ground when it is loaded.
- Strap loads to the cart whenever necessary to maintain stability.
- Do not modify the cart. Modifications might make the cart unsafe to use and automatically void the limited warranty.
- Do not use the cart unless all labels are in place and easily readable. (See "Labeling Diagram" on p. 5.)

Exploded Parts Diagram and Bill of Materials

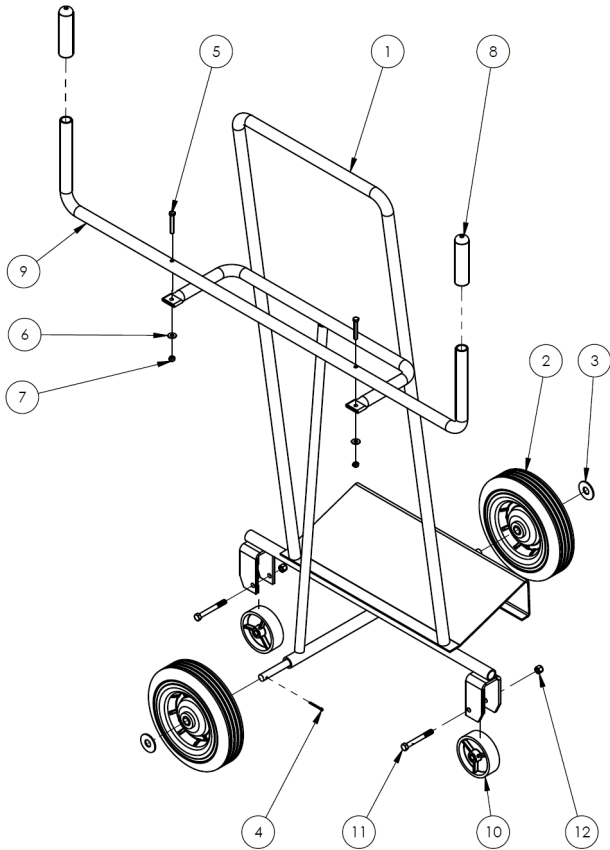

Item	Part No.	Description	Qty.
1	33-514-090	Weldment, frame	1
2	16-132-310	Wheel, semi-pneumatic, 10" x 2 1/2", 16mm steel hub	2
3	33016	Flat washer, low carbon, USS, zinc plated, 5/8"	2
4	65078	Extended prong cotter pin, zinc finish, 1/8" x 1 1/2"	2
5	11011	Hex bolt, grade A, zinc plated, 1/4" - 20 x 2"	2
6	33004	Flat washer, USS, zinc plated, 1/4"	2
7	37018	Nylon lock nut, grade 2, zinc finish, 1/4" - 20	2
8	13-025-037	Handle, grip, black, 1" I.D.	2
9	33-014-093	Frame, handle, formed	1
10	16-132-007	4" x 1 1/4" semi steel wheel (3/8" plain bore)	2
11	11116	Bolt, HHCS #2, zinc plated, 3/8" x 3 1/4"	2
12	37024	Nylon insert lock nut, grade 2, zinc finish, 3/8" - 16	2

Assembly Instructions: Numbers in parentheses correspond to item numbers in the bill of materials (above).

Step 1: Press the handle grips (8) onto the ends of the formed handle (9). Then, fasten the handle (9) to the frame (1) with the hardware shown below.

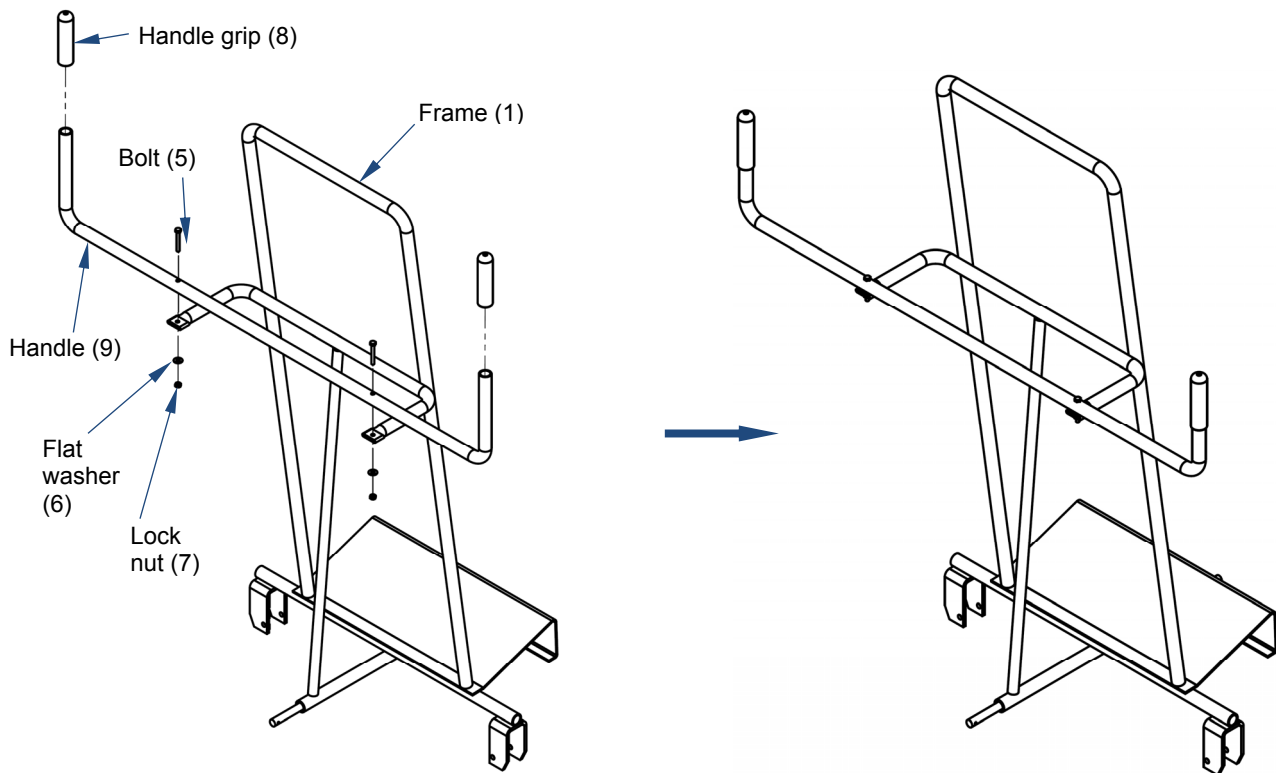

Step 2: Attach the steel wheels to the wheel brackets using the hardware indicated in the diagram.

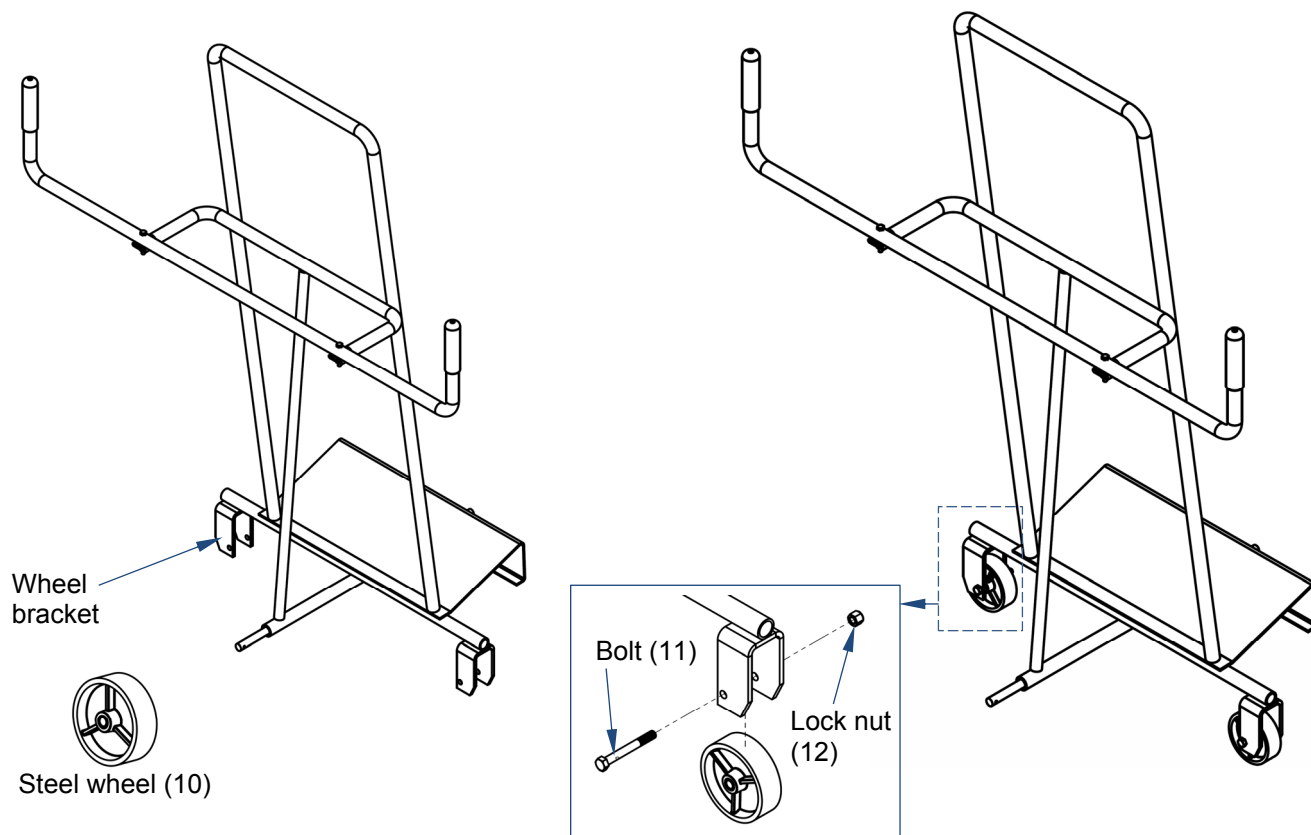

Step 3: Attach the pneumatic wheels (2) to the axle with flat washers (3) and cotter pins (4).

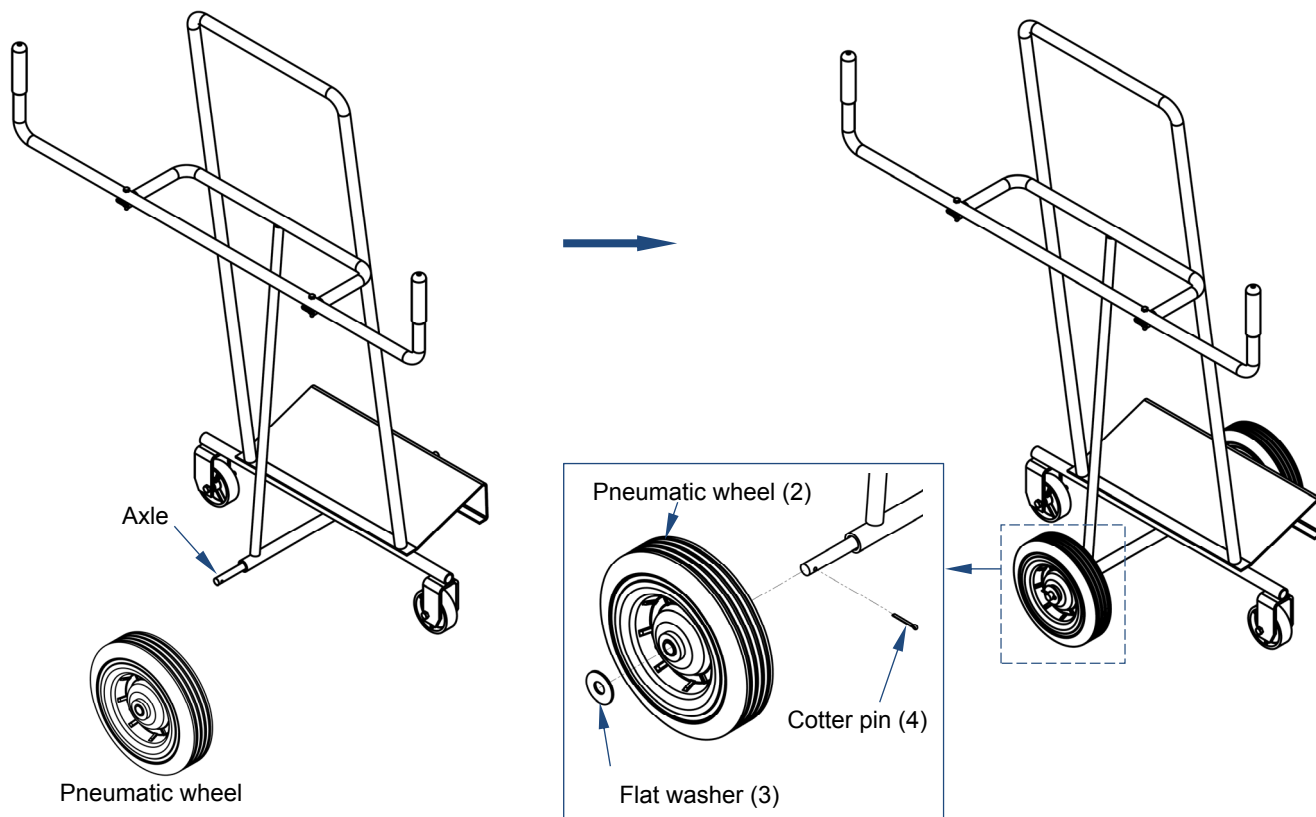

Loading instructions:

This cart is designed to carry sheet material. Set sheet material on the load deck and carefully lay it against the supporting frame. Center the material on the deck. If necessary, adjust the location of the material so that it balances.

Maintenance:

At least once per month:

1. Inspect all fasteners used to attach the handle and the wheels to the frame. Confirm that all hardware is in normal condition and tightly fastened together. Tighten loose fasteners and replace any item that is broken or severely worn.
2. Inspect all 4 wheels, the wheel brackets, and axles. Replace any wheel that is significantly worn, e.g. does not roll smoothly or is cracked. Lubricate wheel pivot points as necessary to allow for quiet, uniform rotation.
3. Check the frame and handle for severe wear, bending, cracked welds, etc. If the handle is severely damaged, contact the factory to order a replacement. Replace entire cart assembly if the frame is damaged.

Labeling diagram:

Only use the cart if it is labeled as diagrammed below. All labels must be readable and undamaged.

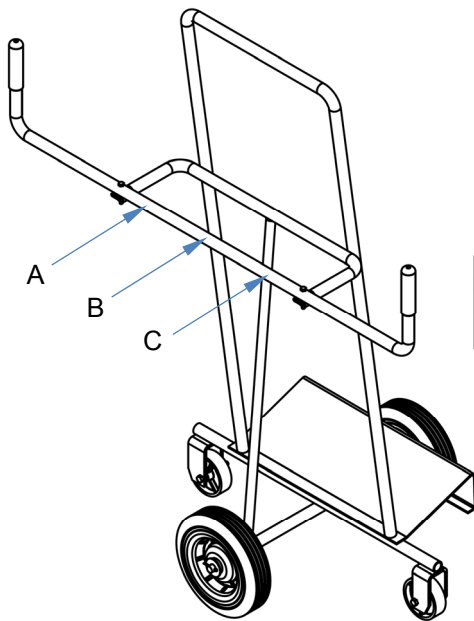

A: Label 287 – Product data label.

MODEL/MODÉLO/MODÈLE	_____
STATIC CAPACITY (evenly distributed)	_____ lbs.
LA CAPACIDAD CONSTANTE (distribuida uniformemente)	_____ kgs.
CAPACITÉ STATIQUE (distribuée régulièrement)	_____ kgs.
SERIAL/SERIE/SÉRIE	_____

287 REV 0812

B: Label 658 – Hazards of improper use

▲ WARNING	▲ ADVERTENCIA	▲ AVERTISSEMENT
Do not operate or move with unstable loads DO NOT LOAD beyond rated capacity DISTRIBUTE LOAD EVENLY DO NOT sit or ride	No use a mueva con cargas inestables No cargue más de la capacidad tasada DISTRIBUYA LA CARGA A NIVEL NO SE SIENTE o vaya en el carro	Ne pas utiliser avec une charge instable NE PAS CHARGER au-delà du débit nominale DISTRIBUER la charge régulièrement NE PAS VOUS ASSEoir OU VOUS PROMENER sur le chariot

658
REV. 0808

C: Label 246 – Do not put loads on handle

▲ WARNING	▲ AVISO
DO NOT place load on handle support bar or handle.	No ponga la carga en el soporte de la manija o en la manija.

246

LIMITED WARRANTY

Vestil Manufacturing Corporation (“Vestil”) warrants product to be free of defects in material and workmanship during the warranty period. *Our warranty obligation is to provide a replacement for a defective original part if the part is covered by the warranty, after we receive a proper request from the warrantee (you) for warranty service.*

Who may request service?

Only a warrantee may request service. *You are a warrantee if* you purchased the product from Vestil or from an authorized distributor AND Vestil has been fully paid.

What is an “original part”?

An original part is a part used to make the product as shipped to the warrantee.

What is a “proper request”?

A request for warranty service is proper if Vestil receives: 1) a photocopy of the Customer Invoice that displays the shipping date; AND 2) a written request for warranty service including your name and phone number. Send requests by any of the following methods:

<u>Mail</u>	<u>Fax</u>	<u>Email</u>
Vestil Manufacturing Corporation 2999 North Wayne Street, PO Box 507 Angola, IN 46703	(260) 665-1339 <u>Phone</u> (260) 665-7586	sales@vestil.com

In the written request, list the parts believed to be defective and include the address where replacements should be delivered.

What is covered under the warranty?

After Vestil receives your request for warranty service, an authorized representative will contact you to determine whether your claim is covered by the warranty. Before providing warranty service, Vestil may require you to send the entire product, or just the defective part or parts, to its facility in Angola, IN. The warranty covers defects in the following original dynamic components: motors, hydraulic pumps, electronic controllers, switches and cylinders. It also covers defects in original parts that wear under normal usage conditions (“wearing parts”), such as bearings, hoses, wheels, seals, brushes, and batteries.

How long is the warranty period?

The warranty period for original dynamic components is 90 days. For wearing parts, the warranty period is 90 days. The warranty periods begin on the date when Vestil ships the product to the warrantee. If the product was purchased from an authorized distributor, the periods begin when the distributor ships the product. Vestil may, at its sole discretion, extend the warranty periods for products shipped from authorized distributors by *up to* 30 days to account for shipping time.

If a defective part is covered by the warranty, what will Vestil do to correct the problem?

Vestil will provide an appropriate replacement for any covered part. An authorized representative of Vestil will contact you to discuss your claim.

What is not covered by the warranty?

1. Labor;
2. Freight;
3. Occurrence of any of the following, which automatically voids the warranty:
 - Product misuse;
 - Negligent operation or repair;
 - Corrosion or use in corrosive conditions;
 - Inadequate or improper maintenance;
 - Damage sustained during shipping;
 - Accidents involving the product;
 - Unauthorized modifications: DO NOT modify the product IN ANY WAY without first receiving written authorization from Vestil. Modification(s) might make the product unsafe to use or might cause excessive and/or abnormal wear.

Do any other warranties apply to the product?

Vestil Manufacturing Corp. makes no other express warranties. All implied warranties are disclaimed to the extent allowed by law. Any implied warranty not disclaimed is limited in scope to the terms of this Limited Warranty.

